



Okudogo Ichiyu No Mori Villa Tsubonakagawa

Royal Suite – Exclusive Private Stay
in a Historic Japanese Residence

奥道後壺湯の守 別邸 坪中川
ロイヤルスイート一棟貸宿泊



A graceful luxury of spending time amidst a historic ambiance and a traditional Japanese garden

Tsubonakagawa is a masterfully relocated and reconstructed establishment, originally an esteemed traditional restaurant from Tokyo's prestigious Akasaka district. The original Nakagawa, established in 1927 (Showa 2), though demolished during wartime relocations, was reborn in August 1951 (Showa 26). Until 1982 (Showa 57), it served as an exclusive gathering place for Japan's most influential figures, including military leaders, financial magnates, and distinguished political personalities.

In preserving this cultural treasure, we have meticulously maintained its authentic elements while refining existing features, creating not merely an experience, but an immersive journey into Japanese architectural excellence and cultural sophistication. The front garden stands as a masterpiece of pure Japanese landscaping—the only garden personally designed by Zenko Adachi, founder of the renowned Adachi Museum of Art. This entire historic estate, with its countless untold stories, is now available as our premier Royal Suite at Okudogo Ichiyu-No-Mori.

Crafted for the world's most discerning connoisseurs of authenticity, our space offers a genuine "Japanesque" experience. We embrace the philosophy of "ichigo ichie"—each moment being a once-in-a-lifetime encounter—celebrating the ephemeral beauty of changing seasons through our carefully curated seasonal cuisine.

Limited to One Group Per Day
Experience cherished moments
in an exclusive, whole-property rental



New Japanese-Style Dining Room



Japanese Garden

Enjoy your meal while admiring the elegantly illuminated karesansui (dry landscape) garden.



Lounge

Showa Nostalgia

This distinguished room holds a rich history as a gathering place for celebrated writers, artists, successive prime ministers, high-ranking bureaucrats, business leaders, and top military officials. Photographs and anecdotes serve as lasting testaments to the conversations that once took place here.

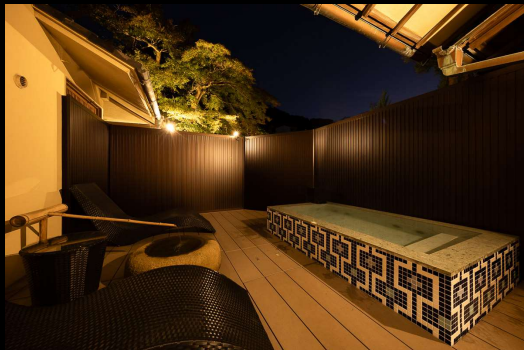

Open-Air Bath (Onsen)

Our open-air bath has been thoughtfully restored with Showa-era mosaic tilework, harmonizing with the building's historical context. The bath is designed as an open and airy space, offering a glimpse of the vibrant green maple leaves in the karesansui, creating a tranquil and liberating atmosphere. At certain moments, you may be privileged to hear nature's gentle symphony—the rustle of leaves and the melodious songs of wild birds.



Bedroom

The sleeping quarters exemplify Showa-modern Art Deco aesthetics, thoughtfully incorporating authentic period elements. The space has been meticulously designed according to the principles of the Five Elements (Wu Xing), with particular attention to the bed's western orientation for optimal wellness.



2nd Floor

This tranquil setting offers an opportunity to experience quiet solitude, practice zazen meditation, or take photographs by the tokonoma alcove. We also accommodate Shugen wedding plans, providing an elegant venue for personalized, non-religious ceremonies.

Savor a Chef's Curated Meal While Admiring the Illuminated Karesansui Garden



Beef Fillet Oil Fondue



Seasonal Kaiseki



Breakfast (Western-style • Japanese-style)

Tsubonakagawa Facility Information

Private Rental Area

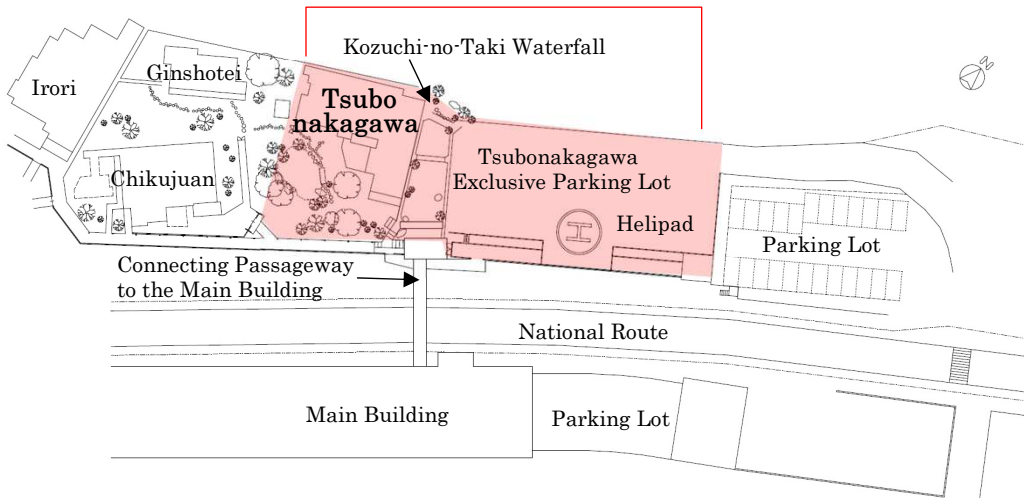

Entire Site Map

Kozuchi-no-Taki Waterfall

Upon arrival, you will be escorted from our exclusive parking lot and helipad, crossing the elegant bridge in front of the picturesque Kozuchi-no-Taki Waterfall to Tsubonakagawa. Please note that the entire property, including our exquisitely maintained garden, is reserved exclusively for your private enjoyment. We invite you to stroll at your leisure and savor the serene surroundings.

Japanese Garden

The front garden stands as a masterpiece of pure Japanese landscaping—the only garden personally designed and supervised by Zenko Adachi, founder of the renowned Adachi Museum of Art.

Tsubonakagawa Exclusive Parking Lot

After check-in, the entrance gate will be closed. If you plan to go out, please inform our staff.

Helipad

If you wish to use the helipad, please inform us at the time of reservation.

Building Area: 424㎡ (1st floor: 235㎡, 2nd floor: 189㎡)
Total Site Area (including front garden): Approx. 200 tsubo (660㎡)
Non-smoking Indoors Capacity: 1–3 guests
Beds: • 2 Queen-size beds (Width: 160cm × Length: 195cm)
 • For 3 guests: 1 Extra bed (Width: 91cm × Length: 189cm)
 • For 4 or more guests: Please contact us for inquiries.
Wi-Fi: Available (Free)
Check-in & Check-out:
 • Check-in: From 3:00 PM • Check-out: By 11:00 AM
 • *Seamless check-in & check-out within the room*

Tsubonakagawa Facility Information

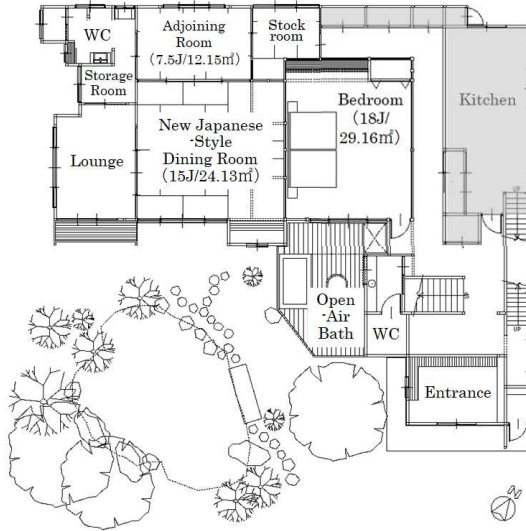

Gray areas are accessible to staff only.

1st Floor Map

Tsubonakagawa Renovation Philosophy

Our primary mission is the preservation of this cultural landmark. Through the application of contemporary techniques and masterful craftsmanship, we have restored the property's original splendor while ensuring its legacy for future generations. Our vision extends beyond mere preservation—we aim to present Japanese architecture, artistry, and cultural heritage to global connoisseurs not simply as observers, but as privileged participants in an immersive experience.

In maintaining absolute authenticity, certain characteristic elements of traditional Japanese wooden architecture remain—such as subtle drafts, natural acoustics, and traditional insulation. While these features may occasionally present modern inconveniences, they are integral to the genuine historical experience we offer.

As befitting a structure of such historical significance, you may notice subtle signs of aging—a testament to the building's rich heritage. The original layout, while meticulously preserved, may present certain spatial arrangements that differ from contemporary designs, particularly in areas such as the washroom and changing areas. We thank you for your understanding that this historical property is not barrier-free.

Equipment and Supplies • Amenities

Stockroom	Refrigerator, Coffee maker, Electric kettle, Glasses, Cups & saucers, Teacups, etc.
Bedroom	Two queen-size beds, Safety box, Air purifier, Hairdryer, Hair iron, Hangers, Clothes brush, Deodorizing spray, Multi-device charger, Bath towels, face towels, hand towels, Bathrobes, Haori (traditional Japanese jacket), Yukata (casual kimono), Pajamas, Slippers, Yukago (hot spring basket)
Storage Room	Trouser press, Iron, Ironing board
Others	Massage chair, TV, Portable speaker, Umbrella, Shoehorn
Amenities	Bath amenities (shampoo, conditioner, body soap), Body towels, Toothbrush set, Skincare products (cleansing oil, facial soap, lotion, serum), Cotton swabs, Cotton pads, Comb, Shower cap, Razor

About the Furnishings at Tsubonakagawa

Please note that we use genuine, original pieces throughout the space. As a result, some items may exhibit natural signs of aging, such as stains, scratches, or minor tears. We appreciate your kind understanding.



1st Floor Entrance

The phrase "Issho Santan" (一嘗三嘆) was used by Masaoka Shiki in a letter to his hometown friend Norito Shimizu (Masaoka Shiki Complete Works, Volume 18, Kodansha, 1977, p. 75). In this letter, Shiki expressed his profound admiration for Matsuyama's sea bream cuisine by modifying the classical phrase "Issho Santan" (一唱三嘆 or 一倡三歎)—which originally means "to be deeply moved time and again while reciting an exceptional poem or literary work." This elegant calligraphy was personally inscribed by the master of Togetsuan in Matsuyama, who oversaw the overall design of Villa Tsubonakagawa.



1st Floor Hallway

This space features a ceremonial crown stand and inkstone box crafted from reclaimed wood from Ginkaku-ji (the Silver Pavilion). The phoenix, a revered symbol of good fortune and prosperity, is elegantly expressed in ceramic form, preserving its legacy as an auspicious work of art passed down through generations.



1st Floor Bedroom – Lamp

A 1930s American Art Deco lamp, reflecting a cultural movement that later influenced Japan's unique early Showa-era Art Deco style. This aesthetic evolution blended curved forms ("Art") with linear elements ("Deco"), ultimately shaping the elegant and distinctive Showa Modern design.



2nd Floor - Folding Screen

On display on the second floor is a magnificent folding screen painted by Shuho Ikegami in early autumn of 1922 (Taisho 11). Ikegami Shuho was a distinguished Japanese painter active from the Meiji to Showa periods, celebrated for his sansui (landscapes) and kachoga (bird-and-flower paintings). He was born in Takato, Kamiina District, Nagano Prefecture (present-day Ina City). His real name was Kunisaburo, and he studied the Kano school style under the official painters of the Takato Domain.



止観明静 前代未聞 酒泛杯中玉 香浮紙上烟

2nd Floor Fusuma (Sliding Doors) - Handwriting by Kon Toko

On display is an original handwritten calligraphy piece by Kon Toko—a novelist, essayist, and Buddhist monk—who lived a truly unconventional life. In December 1975 (Showa 50), during his visit to this retreat, he noticed the fusuma (sliding doors) in the banquet hall were plain. Finding them too bare, he remarked, "It looks a bit lonely. Let me add a touch of life to these," and with swift, spontaneous brushstrokes, he inscribed two remarkable calligraphy pieces on the spot.

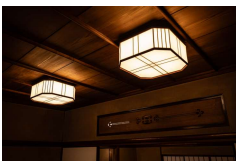

Lighting Fixtures

Only the bulbs have been upgraded to LED, while the original lighting fixtures from the period have been carefully preserved and used wherever possible.



Okudogo Ichiyu No Mori Villa Tsubonakagawa
奥道後赤湯の守 別邸 坪中川

Inquiries & Reservations

Tel +81 89-977-1111

〒791-0122

267-1 Suemachi, Matsuyama City, Ehime Prefecture



Official Website